



# Delta P Carver

We Put the PSI in Water Systems

- Designed for Noise Sensitive Locations - Hotels/Condos/Hospitals
- Wall mounted or Designed to Specification
- 304 SS Construction for Indoor or Outdoor Mounting
- Ideal for Buildings Over 15 Floors with Limited Space
- High Pressure Booster System for Applications up to 1000 Feet TDH
- 1 Year Warranty
- Variable Speed Drives



## Quiet Pak

### Domestic Water Booster Systems

Custom Engineered for Reliability & Efficiency

[www.deltapcarver.com](http://www.deltapcarver.com)

[sales@deltapcarver.com](mailto:sales@deltapcarver.com)

Among its many advantages, the Quiet Pak offers the technical design features of:

- ▲ Pre-engineered standard system (Simplex, Duplex and Triplex)
- ▲ Programmable set points
- ▲ VFD controls
- ▲ 3 phase (208-230/460) power
- ▲ Simple system design with a pressure transducer and gauge
- ▲ Pumps and motors\* certified to NSF/ANSI 61 & 372
- ▲ Flows up to 900 Gallons per minute

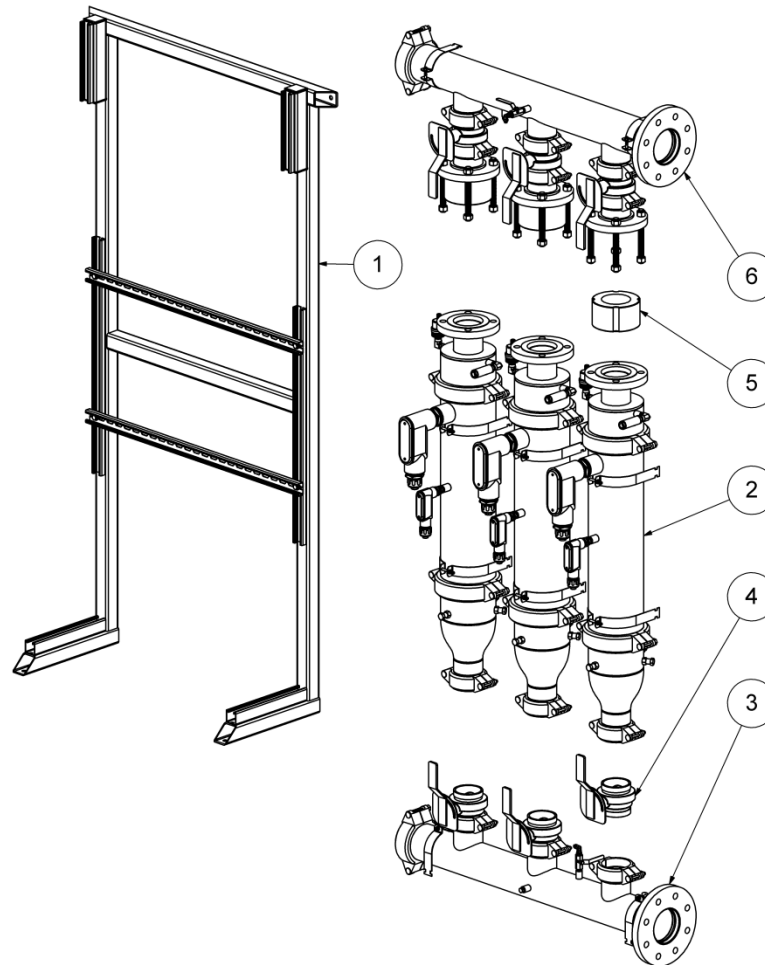

| ITEM NO. | DESCRIPTION      |
|----------|------------------|
| 1        | FRAME            |
| 2        | SLEEVE ASSEMBLY  |
| 3        | SUCTION MANIFOLD |

| ITEM NO. | DESCRIPTION               |
|----------|---------------------------|
| 4        | BUTTERFLY ISOLATION VALVE |
| 5        | WAFER CHECK VALVE         |
| 6        | DISCHARGE MANIFOLD        |

\*Motors certified by UL to NSF/ANSI 61 & 372